



MASSEY UNIVERSITY
WELLINGTON

O.W.W! 2010 Orientation Welcome Week

Your Welcome Programmes at Massey University Wellington
Commences 15th February 2010

Te Kunenga
ki Pūrehuroa



Orientation Welcome Week

Nau mai – welcome

It is a great pleasure to join with our academic, student support and service staff in welcoming all new students to the Campus, whether you are from Wellington, from other parts of New Zealand or from countries overseas. You have each made a great decision to come to Massey University Wellington, to study and achieve a qualification which will launch you on the career path of your choice.

Orientation is designed to welcome and prepare you for one of the most important experiences of your lives. Orientation week includes College, Campus and social activities to get you off to a good start for the academic year. It will familiarise you with Student Services which can provide assistance to ease your way, and introduce you to activities which you can share with other students and help you to feel comfortable in your new environment.

This booklet is the key to getting started on a programme to help you feel part of Massey University; a university which values academic excellence and cultural diversity, promotes social interaction, and where you can achieve your academic goals.



Professor Andrea McIlroy
Regional Chief Executive
Wellington Campus

There are always building developments occurring on this campus. We apologise for any inconvenience these cause but I know that you will share our enthusiasm for this important campus renewal. Ongoing improvements to the campus buildings and facilities benefit us all. Over this year you will notice preparation work underway for the College of Creative Arts new building adjacent to the Engine Room Gallery. An extension to and redevelopment of the library is next. It will be exciting to watch these developments taking shape.

We meet each academic year with enthusiasm, in anticipation of the energy, talents and diverse influences you each contribute to the campus, making it a richer place. Make the most of Orientation Welcome Week, attend a Study Smart programme and begin your university life with confidence. We look forward to celebrating your Graduation with you when you achieve your academic goals.

Enjoy Orientation Welcome Week. Have a successful and satisfying year.

I look forward to meeting many of you during your time with us at Massey University – Wellington.

With best wishes
Professor Andrea McIlroy

Contents

Welcome4

College Welcomes5

College of Business6

College of Creative of Arts.....8

College of Humanities and
Social Sciences.....10

College of Sciences.....12

Orientation Events14

Study Smart Programme.....14

Extramural Students14

International Students.....15

Māori Students.....15

Pasifika Students16

Mature Students and Students
who are Parents.....16

New Zealand School of Music16

Massey University Scholarship
Recipients.....17

BPM Fitness Programme.....17

On Campus Support Services18

Student Liaison Advisers18

Disability Support Services18

Student Learning Support18

Pasifika Services.....18

Student Services Trust19

Māori Academic Support Services19

MAWSA.....19

Events Timetable.....20

Plan your day (Individual timetable) ...21

Campus Map.....22, 23



Welcome to Orientation

Massey University Wellington, is delighted to welcome all new students to our Creative Campus, situated in the creative hub of Wellington city. Our Orientation programme will give you all the necessary information for a head start. Please read this booklet carefully so you know what to attend.

You need to check your College Welcomes and the following pages to ensure you are not missing out. Use the dedicated timetable on Page 21 to create your own programme; all events are strongly recommended. Attending Orientation will give you the best possible start to a successful academic life at Massey Wellington. See you there!

Venues

Most venues in this booklet are written in three parts:

- Block (number)
- Level (letter)
- Room (number)

For example 4B06, Block 4, Level B, Room 06

See the map on page 22 to help you find your way around campus.



College Welcomes

You are warmly invited to attend your college orientation programme which you will find on the following pages. This is a fantastic opportunity for you to meet your lecturers, other students and your uni-guide. Your programmes may include:

- **Pōwhiri** – traditional Māori welcome bringing together Hosts (Tangata Whenua) and Visitors (Manuhiri) usually at a Marae (Māori community centre) in a welcoming environment of friendship and generosity. The welcome acknowledges those who have gone before us and the sanctity of culture. The Pōwhiri includes Karanga (calling ritual), Hongi (nose pressing), Whaikōrero (formal speeches), Waiata (songs), and Kai (food).
- **Mihi Whakatau** – less formal Māori welcome of acknowledgement to guests and the environment. Literally 'Whakatau' means 'to be settled'.
- **Academic Advice** – is time allocated for students who have not had their

enrolment confirmed or wish to make changes to their paper selections.

- **Uni-guides** – senior students who will be available to provide support, information and friendly advice as you adjust to University life. They will take you on a tour of the campus and show you where your lecture rooms are located.
- **Workshops** – are designed to give you a head start. Don't miss them!
 - Studylink:** money, money, money - get it sorted!
 - Library:** the key to success and study tips too good to miss.
 - MAWSA:** find out what your student association can do for you.
 - Careers:** So what ARE you going to be when you grow up?
 - ITS:** learn about lab facilities, email, network access and internet usage.
 - Uni-speak:** learn the jargon in preparation for classes.

Welcome from the College of Business

- Bachelor of Business Studies (BBS)
- Bachelor of Accountancy (BAcc)
- Bachelor of Communication (BC)
- Certificate of Business Studies (CertBusStuds)
- Graduate Diploma in Business Studies (GradDipBS)
- Graduate Diploma in Journalism (GradDipJ)
- Graduate Diploma in Journalism Studies (GDipJS)
- Bachelor of Business Studies Honours (BBS Hons)
- Postgraduate Diploma Business and Administration
- Postgraduate Certificate of Business and Administration
- Master of Business (MBS)
- Master of Management (MMgt)
- PhD



FEB 2010	TIMES	ACTIVITY	STUDENTS REQUIRED	VENUE		
				BLOCK	LEVEL	ROOM
Mon 15 th	9.30am-12noon	Academic Advice	CertBusStuds, BBS, BAcc, BC, Grad Dip BS	5	D	22
	1.30pm-3.30pm	Academic Advice	CertBusStuds, BBS, BAcc, BC, Grad Dip BS	5	D	22
Tue 16 th	9.30am-12noon	Academic Advice	CertBusStuds, BBS, BAcc, BC, Grad Dip BS	5	D	22
	1.30pm-3.30pm	Academic Advice	CertBusStuds, BBS, BAcc, BC, Grad Dip BS	5	D	22
Wed 17 th	9.30am-12noon	Academic Advice	CertBusStuds, BBS, BAcc, BC, Grad Dip BS	5	D	22
	1.30pm-3.30pm	Academic Advice	CertBusStuds, BBS, BAcc, BC, Grad Dip BS	5	D	22
Thur 18 th	9.30am-12noon	Academic Advice	CertBusStuds, BBS, BAcc, BC, Grad Dip BS	5	D	22
	1.30pm-3.30pm	Academic Advice	CertBusStuds, BBS, BAcc, BC, Grad Dip BS	5	D	22
	1.30pm	ITS Workshop	BC Students	4	B	06
	2.30pm-3.30pm	Workshops 1 StudyLink 2 Library 3 MAWSA 4 Careers	BC Students	4	B	06
Fri 19 th	9.30am-12noon	Academic Advice	CertBusStuds, BBS, BAcc, BC, Grad Dip BS	5	D	22
	9.30am	ITS Workshop	All new students (other than BC students)	4	C	09
	10.30am	Workshops 1 StudyLink 2 Library 3 MAWSA 4 Careers	All new students (other than BC students)	4	C	09
	10.00am-12pm	Bachelor of Communication Welcome Uni guide and Campus Tour	BC Students	4	B	06
	12noon	Pizza Lunch	BC Students	Block 7 Court Yard		
	12 noon	Lunch	All new students (other than BC students)	Student Centre Level 1 Student Common Room		
	1.00-3.00pm	College Welcome, <i>Mihi Whakatau</i> Uni-guide and Campus tour	All new students (other than BC students)	6	C (LT200)	15

Welcome from the College of Creative Arts

- Bachelor of Design Honours (BDes Hons)
- Bachelor of Fine Arts Honours (BFA Hons)
- Postgraduate Diploma in Design (PGDipDes)
- Postgraduate Diploma in Fine Arts (PGDipFA)
- Graduate Diploma in Design (GDipDes)
- Certificate in Art & Design Studies (CertArtDesStud)
- Diploma in Photography (DipPhoto)
- Diploma of Fashion, Design & Technology (DipFDT)

Administrative offices

- College of Creative Arts Academic Office:
Museum Building Room 10A84
- Institute of Design for Industry and Environment:
Museum Building Room 10A84
- School of Visual and Material Culture:
Museum Building Room 10A102
- Institute of Communication Design:
Museum Building Room 10A51
- School of Fine Arts:
Block 1 Room 1C13



FEB 2010	TIMES	ACTIVITY	STUDENTS REQUIRED	VENUE		
				BLOCK	LEVEL	ROOM
Mon 15 th	9.00am-3.00pm	Art and Design supplies sales/orders	All new students	10	B	Foyer (Great Hall Foyer)
	9.00am-3.00pm	Study Smart (see page 14)	All new students	4	B	06
Tue 16 th	9.30am-11.00am	<i>Pōwhiri</i> & College Welcome See CoCA Induction Booklet	All new students	Assemble at the front steps of the Museum Building		
	11.00am-12.30pm	Uni-guide and Campus tour	All new students Note: Dip Fash Des & Tech separately	10	B	10 (Great Hall)
	1.00pm-4.00pm	Academic Advice	All new students	10	A	84
Wed 17 th	9.00am-3.00pm	Art and Design supplies sales/orders	All new students	10	B	Foyer (Great Hall Foyer)
	9.00am	Uni-speak	All new students	10	A	02 (Theatrette)
	9.30am-10.30am	Workshop: Using Computers at Massey	All new students	10	A	02
	11.00am-12.00pm	Workshops 1 StudyLink 2 Library 3 Students Association 4. Careers	All new students	10	A	02
	1.00pm	Uni-speak	All new students	10	A	02
	1.30pm-2.30pm	Workshop: Using Computers at Massey	All new students	10	A	02
Thur 18 th	9.30am-10.30am	Degree Briefing A-L	All new students	10	A	02
	10.30am-11.30am	Degree Briefing M-Z	All new students	10	A	02
	1.00pm-4.00pm	Subject briefings: Fine Arts, Photography, Visual Communication, Textiles, Fashion, Industrial Design, Spatial Design	School of Fine Arts (SoFA); Institute of Communication Design (ICD); Institute of Design for Industry and Environment (IDIE)	10	A	02
Fri 19 th	9.00am-3.00pm	Academic Advice	All new students	10	A	84
	10.00-12.00pm	Creative Arts International Students: Workshop	CoCA International and Study Abroad students	5	B	14

Welcome from the College of Humanities and Social Sciences

- Certificate in Arts (CertArts)
- Diploma in Health Science (DipHlthSc)
- Diploma in Arts (DipArts)
- Bachelor of Communication (BC)
- Bachelor of Health Science (BHlthSc)
- Bachelor of Midwifery (BMid)
- Bachelor of Nursing (BN)

- Postgraduate Diploma in Public Health
- Postgraduate Diploma in Social Sector Evaluation Research
- Master of Arts (MA)
- Master of Nursing (MN)
- Master of Public Health (MPH)
- Doctor of Philosophy
- Doctor of Clinical Psychology



FEB 2010	TIMES	ACTIVITY	STUDENTS REQUIRED	VENUE		
				BLOCK	LEVEL	ROOM
Mon 15 th	9am-4pm	Academic Advice	All new students	7	C	Reception College Office
Tues 16 th	9am-4pm	Academic Advice	All new students	7	C	
Wed 17 th	9am-4pm	Academic Advice	All new students	7	C	
Thurs 18 th	9.30am	<i>Pōwhiri</i> & College Welcome	BN; B Mid; B HlthSc; Cert HlthSc; BA; Dip Arts; Cert Arts; and all new Postgraduate students	Te Kuratini Marae		
	11.30am	Meet your Uni guide and Campus Tour	BN; B Mid; B HlthSc; Cert HlthSc; BA; Dip Arts; Cert Arts; and all new Postgraduate students	Te Kuratini Marae		
	12.15pm	BBQ Lunch	All new students	Wharekai		
	1.15pm	Thanks to our hosts	All new students	Te Kuratini Marae		
	1.30-2.30pm	ITS Workshop	All new students	4	B	06
	2.30pm- 3.30pm	Workshops 1 StudyLink 2 Library 3 MAWSA 4 Careers	All new students	4	B	06
	2.45-4.30pm	Academic Advice	All new students	7	C	Reception College Office
Fri 19 th	10am	Bachelor of Communication Welcome	BC Students	4	B	06
	11.30am	Meet your Uni guide and Campus Tour	BC Students	4	B	06
	12noon	Lunch	BC Students	Block 7 Court yard		

Welcome from the College of Sciences

School of Engineering and Advanced Technology

- Bachelor of Engineering (Honours)
 - Mechatronics
 - Multimedia Systems Engineering
 - Product Design Engineering
- Postgraduate Diploma in Engineering
- Master of Engineering
- PhD

Institute of Food Nutrition and Human Health

- Bachelor of Health Science
 - Human Health and the Environment
 - Sport and Exercise
- Diploma in Health Science
- Graduate Diploma in Environmental Health
- Postgraduate Diploma in Health Science
- Master of Health Science
- Postgraduate Diploma in Health Science
- Master of Science
- PhD Science and PhD Health Science



FEB 2010	TIMES	ACTIVITY	STUDENTS REQUIRED	VENUE		
				BLOCK	LEVEL	ROOM
Mon 15 th and Tue 16 th	9.00am-3pm	Maths Workshop	BE (Hons)	4	D	27/28
	9.00am-4pm	Academic Advice	Available to all students	3	D	13
Wed 17 th	9.00am	Mihi Whakatau Welcome	All first year students	4	B	06
	9.05am	Introduction of Key staff Outline of College structure	All first year students	4	B	06
	9.20am	Profile of the College, Schools and Institutes	All first year students	4	B	06
	10.00am	Morning Tea & Competition	All first year students	3D Corridor		
	10.30am	Academic approval	All first year students (split by programmes)	3	D	13
	12.00pm	Uni-guide and Campus tour	All first year students	3	D	13
	12.30pm	Lunch	All first year students	Student Common Room		
	1.30-2.30pm	Workshops: 1. Library 2. StudyLink 3. MAWSA 4. Careers	All first year students	4	B	06
	2.30pm	Health and Life Sciences Workshop	DipHlthSci, BHlthSci, GradDipEH, BNursing	4	B	06
	2.30pm	Introduction to Engineering Workshop	BE (Hons)	4	D	27/28
Thur 18 th	9.00am-5pm	Engineering Workshop	BE (Hons)	4	D	27/28
	9.00am-4pm	Academic Advice	Available to all students	3	D	13
Fri 19 th	9.00am-3pm	Engineering Workshop	BE (Hons)	4	D	27/28
	9.00am-4pm	Academic Advice	Available to all students	3	D	13

Orientation Events

If any of the following welcomes apply to you, do attend.

Sat 13th Feb Extramurals on Campus

A chance for newly enrolled extramural students in the Wellington area to learn about the services that are available to support their study, and to meet other students studying extramurally. This is for both undergraduate and postgraduate students. Please note that it will follow a similar programme to that held on the Palmerston North campus. If you would like academic advice please contact your paper coordinator directly as it will not be covered in this session. Please register if you wish to attend: n.taumoepeau@massey.ac.nz

Time: 10.00am to 1.00pm

Where: Block 6, Level C, Room 15 (also known as LT200)

Mon 15th Feb & Tues 16th Feb Study Smart

Study Smart is an introductory academic writing and study skills programme run by the Student Learning Centre for newly-enrolled students at Massey University. You can choose to attend either of the following programmes:

Programme 1: Recommended for students of the College of Creative Arts

Date: Monday, 15 February

Time: 9.00am – 3.00pm

Where: Block 4, Level B, Room 06

Programme 2: Recommended for students of other Colleges

Date: Tuesday, 16 February

Time: 9.00am – 3.00pm

Where: Block 5, Level C, Room 19

The registration fee is \$25. A brochure containing a registration form is enclosed with this booklet and can be downloaded from the Student Learning Centre's web pages. For further information email n.taumoepeau@massey.ac.nz or phone 04 801 5799 ext 6843. This is a popular programme so please register early.

Mon 15th & Tue 16th Feb International Student Orientation

All International Students are required to attend a two day programme.

Monday 15th: Welcome *Pōwhiri* (traditional Māori welcome). Meet other students, enjoy fun activities, a tour of the campus and a tour of Wellington.

Time: 8.30am

Where: Pyramid (Entrance A, 63 Wallace Street)

Wednesday 17th: Study Smart Programme. Learn about academic writing and study skills you will need for your coursework, and find out about the learning and teaching styles used at Massey University. Register at the Student Learning Centre (Block 5, Level A) or email Janet Wutzler at: j.r.wutzler@massey.ac.nz

Time: 1pm – 3pm

Where: Block 5, Level C, Room 19

Tue 16th & Wed 17th Feb After Work Academic Skills Session

An introductory academic writing and study skills programme run by the Student Learning Centre for undergraduate extramural students and mature students returning to tertiary study.

Please register if you wish to attend: n.taumoepeau@massey.ac.nz

Time: 6.00pm – 8.30pm (both days)

Where: Block 5, Level B, Room 14 (The Executive Seminar Suite)

Tue 16th Feb Māori Students

Kia ora koutou. A *Pōwhiri* will be held at Te Kuratini Marae for all Māori students and their Whānau. It includes information about study at university, an introduction to Māori staff, and services. This is a great opportunity for you to meet other Māori students. Everyone is welcome.

Time: 1.30pm – 3.30pm

Where: Te Kuratini Marae, Entrance E, Tasman Street

Wed 17th Feb Pasifika Students

Make a great start to 2010 and take part in the Pasifika Orientation. We will begin with a powhiri at Te Kuratini Marae and then head to our Pasifika Room to provide you with handy information to get you started and on the way! Fun activities and afternoon tea are all included in the day's programme. Bring your families along too!

Time: 1.30pm – 3.30pm

Where: Assemble in front of Te Kuratini Marae.

The programme continues in the Pasifika Room (5D21).

Thur 18th Feb Mature Students and Students who are Parents

A networking opportunity for all Mature Students and Students who are parents to meet each other. Come and join the Director, Corporate and Student Services for drinks and nibbles. Your partner and children are most welcome. Register your attendance by emailing the Events Office wgtnevents@massey.ac.nz

Time: 4.00pm - 5.30pm

Where: Student Centre, Level 1, Student Common Room

Thur 25th Feb New Zealand School of Music

All new students to New Zealand School of Music will receive information about the joint Orientation programme Massey University Wellington / Victoria University, giving you an introduction to the School and the opportunity to visit both locations.

Please refer to www.nzsm.ac.nz for further information or phone 04 801 5799 extn 62440.

Mon 15th - Fri 26th **BPM fitness studio**

This year, the team at the BPM Fitness Studio are offering a range of group exercise classes as well as personal training. Come and try our classes and events during Orientation to get your University year off to a high energy start! *Introductory classes held Mon-Thurs at 4.15pm are free throughout Orientation. See the timetable on Page 20.*

Sat 20th: 1pm - Amazing Race

Sun 21st: 1pm - Team sports afternoon

Drop by the Fitness Studio to sign up or turn up on the day. All events start at BPM (T32).
www.bpmfitness.co.nz

Wed 3rd March **Massey University Scholarship Recipients**

The Regional Chief Executive will be hosting a welcome lunch for Massey University Scholarship Recipients. An invitation will be issued to you in February. RSVP required.



On Campus Support Services

The University offers many services to help students through their studies. With friendly and approachable staff in all departments, you can ask for help and advice, any time!

Student Liaison Advisers

The Student Liaison Advisers are here to help you plan your course of study at Massey and can discuss services on campus, life in Wellington and first-year studies.

Opening hours: Monday to Friday, 12pm to 2pm (during Orientation)

Location: Student Central

Disability Support Services

The Disability Support Service is committed to engendering academic success through providing a variety of support mechanisms relating to coursework, exams, and advocacy for all Massey students with disabilities. It is important that all students interested in accessing Disability Support Services discuss their support needs with staff on a one-to-one basis, so please drop in to the office at any time during Orientation Week.

Opening hours: Monday to Friday, 9am to 4pm (during Orientation)

Location: Disability Support Services Office, T33

Student Learning Centre

The Student Learning Centre's learning advisors and peer tutors can assist you to develop the academic writing and study skills you need at university. Call in to make an appointment or phone 04 801 5799 extn 6843.

Opening hours: Monday to Friday, 9am to 5pm **Location:** Block 5, Level A (opposite to the Copy Centre)

Pasifika Services

Talofa lava! Bula vinaka! Malo e Lelei! Taloha ni! Fakaalofa lahi atu! Kia orana katoatoa! Information and support services are available to enhance the learning outcome and experience of Pasifika students on the Wellington campus. Contact: Pasifika Development & Learning Advisor, Rachael Leafe, r.leafe@massey.ac.nz

Location: Student Learning Centre, Block 5, Level A

Student Services Trust (SST)

The mission of Student Services Trust at Massey Wellington is enhancing students' university experience, wellbeing and success by providing outstanding, professional services from entry to graduation. Any surplus generated by SST are returned to student services on campus. **Services include:**

- Student Health & Counselling Centre
- Common Room Facilities
- Tussock (Licensed Café)
- On-campus social sports leagues
- Budget Adviser
- Hardship Fund
- Vending Machines
- Museum Café
- Bennetts Bookstore
- Dental Service Access
- Student Car Parking
- DIY Kai
- BPM Fitness Studio
- Chaplaincy

Your uni-guide will point out each service during the campus tour and show you how to enrol with the Student Health PHO, get the Orientation Special BPM membership or make contact with the dental service or chaplains.

MAWSA – Your Students' Association

Mawsa is run by young people - many of us are recent students - we know how you tick. It's our job to support you in your studies and show you a good time.

We offer a helpful advocate (problem solver), a radio station (you wanna be a DJ?) a sweet magazine (get your stuff published!), orientation gigs, parties (+ more parties), clubs, Student Job Search, free food and fruit, a free fax and phone, free student diaries and wall planners, subsidised sports trips, hardship grants, class grants, student representation (and did we mention parties?) Don't be a stranger...

For everything you need to get started at Massey Wellington www.mawsa.org.nz

Māori Academic Support Services

Māori Academic Support Services are facilitated through the office of the Te Kaiwawao. Services include learning advice, pastoral care, academic advice and Māori community engagement. The services can be accessed at anytime via the Kaiwhakarite Raupapa (Dale Morgan) located in the office of the Te Kaiwawao attached to the Regional Chief Executive, or online at www.masseyponke.ac.nz. Nau mai haere mai.

Orientation Events Timetable

FEBRUARY				
Monday 15 th	Tuesday 16 th	Wednesday 17 th	Thursday 18 th	Friday 19 th
8.30am-4.30pm International Orientation <i>Common Room</i>	9am-3pm Study Smart <i>5C19</i>			
9am-3pm Study Smart <i>4B06</i>	1pm City walking tour <i>(departs The Cube)</i>	1pm City walking tour <i>(departs The Cube)</i>	1pm City walking tour <i>(departs The Cube)</i>	1pm City walking tour <i>(departs The Cube)</i>
	1.30 - 3.30pm Maori Powhiri <i>Marae</i>	1.30 - 3.30pm Pasifika Powhiri <i>Marae</i>		
4.15pm-5pm Yoga FREE Intro <i>BPM Fitness Studio</i>	4.15pm-5pm Combat FREE Intro <i>BPM Fitness Studio</i>	4.15pm-5pm Bootcamp FREE Intro <i>BPM Fitness Studio</i>	4.15pm-5pm Recreation FREE Intro <i>BPM Fitness Studio</i>	
		5.00pm College vs College Quiz night <i>Tussock Cafe</i>	4pm-5.30pm Mature Students & students who are parents <i>Common Room</i>	
	6.00pm-8.30pm Academic Skills for Extramurals and Mature Students <i>5B14</i>	6.00pm-8.30pm Academic Skills for Extramurals and Mature Students <i>5B14</i>		7.30pm MAWSA welcomes new students at the Fresher's party in <i>Tussock Cafe</i>

Plan Your Day - Individual Timetable

FEBRUARY				
Monday 15 th	Tuesday 16 th	Wednesday 17 th	Thursday 18 th	Friday 19 th

Look out for Tussock Orientation Specials and include social breaks in your timetable.



Map



Campus Maps

These maps give you an overview of the campus layout. Classes take place across all areas. Please make yourself familiar with these locations.

Key

- P Pyramid
- C Copy Centre
- L Library
- S Student Central
- A Accommodation Services
- D Disability Support Services
- R Recreation Centre

- ★ Entrance
- P Student Parking
- B Bus Stop
- ☕ Cafe
- 🍳 Kitchen facilities
- \$ ATM

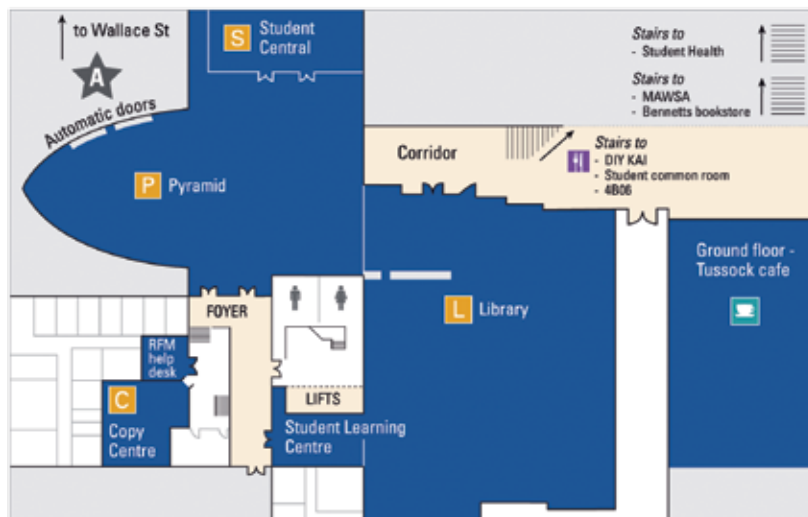

LEFT: Map of Massey University Campus

ABOVE: Map of Block 4 and 5 and Student Centre Building

mawsa
Māori and Whānau Student Association

20 ORI ENT ATI ON

MAWSA
PROUDLY PRESENTS

ORIENTATION 2010

22 – 27th FEBRUARY

A WEEKS WORTH
OF EVENTS,
ENTERTAINMENT
& FREE STUFF
DESIGNED TO GIVE
YOU THE WELCOME
YOU DESERVE

www.mawsa.org.nz

